

BEFORE THE ILLINOIS POLLUTION CONTROL BOARD

Logan Fertilizer )  
(Property Identification Number ) PCB 16-  
10-27-100-008) (Tax Certification)  
)

NOTICE

Steve Santarelli  
Illinois Department of Revenue  
101 West Jefferson  
Post Office Box 19033  
Springfield, Illinois 62794

John Theirrault, Clerk  
Illinois Pollution Control Board  
James R. Thompson Center  
100 West Randolph Street, Suite 11-500  
Chicago, Illinois 60601

Edward Logan  
P.O. Box 555  
Griggsville, Illinois 62340

PLEASE TAKE NOTICE that I have today filed with the Office of the Clerk of the Pollution Control Board an APPEARANCE and RECOMMENDATION OF THE ILLINOIS ENVIRONMENTAL PROTECTION AGENCY, a copy of which is herewith served upon you.

ILLINOIS ENVIRONMENTAL PROTECTION AGENCY

By: Vera Herst  
Vera Herst  
Assistant Counsel  
Division of Legal Counsel

DATED: March 31, 2016

Illinois Environmental Protection Agency  
1021 North Grand Avenue East  
Post Office Box 19276  
Springfield, Illinois 62794-9276  
(217) 782-5544

THIS FILING IS SUBMITTED ON RECYCLED PAPER

**BEFORE THE ILLINOIS POLLUTION CONTROL BOARD**

**Logan Fertilizer** )  
**(Property Identification Number** ) **PCB 16-**  
**10-27-100-008)** ) **(Tax Certification)**  
 )

**APPEARANCE**

The undersigned, as one of its attorneys, hereby enters an **APPEARANCE** on behalf of Respondent,  
Illinois Environmental Protection Agency.

**ILLINOIS ENVIRONMENTAL PROTECTION AGENCY**

By:   
Vera Herst  
Assistant Counsel  
Division of Legal Counsel

DATED: March 31, 2016

Illinois Environmental Protection Agency  
1021 North Grand Avenue East  
Post Office Box 19276  
Springfield, Illinois 62794-9276  
(217)782-5544  
217.782.9143 (TDD)

**BEFORE THE ILLINOIS POLLUTION CONTROL BOARD**

Logan Fertilizer )  
(Property Identification Number ) PCB 16-  
10-27-100-008) (Tax Certification)  
)

**RECOMMENDATION OF THE ILLINOIS  
ENVIRONMENTAL PROTECTION AGENCY**

The Illinois Environmental Protection Agency ("Illinois EPA") hereby files its Recommendation pursuant to Section 125.204 of the regulations of the Illinois Pollution Control Board ("Board"), 35 Ill. Adm. Code 125.204.

1. On September 16, 2013, the Illinois EPA received a request from James and Edward Logan, dba Logan Fertilizer (log number TC-19-13, Exhibit A) for an Illinois EPA recommendation regarding the tax certification of water pollution control facilities pursuant to 35 Ill. Adm. Code 125.204.
2. The facility's address is: Logan Fertilizer  
30571 State Highway 107  
Griggsville, IL 62340

The proposed water pollution control facilities in this request are located in the Section 27, T4S, R3W of the 4th P.M. in Pike County, at the above street address and consist of the following:

Agrichemical containment facilities consisting of the concrete operational containment structure measuring 54.5 ft. x 58 ft. x 0.29 ft.; the portion of the fertilizer building over the concrete operational containment structure measuring 54.5 ft. x 58 ft. x 0.29 ft.; the concrete secondary containment structure (SC-3) for bulk liquid pesticides measuring 48 ft. x 88 ft. x 0.67 ft.; and the portion of the building over the concrete secondary containment structure (SC-3) measuring 48 ft. x 88 ft. x 0.67 ft. as

**THIS FILING IS SUBMITTED ON RECYCLED PAPER**

permitted under the endorsed Agrichemical Facility Permit No. AC94082989, Log. No. 14091489, issued November 25, 2015.

These agrichemical containment facilities are used to collect, transport and/or store agrichemicals prior to cropland application, and are further described in Exhibit A.

3. Section 11-10 of the Property Tax Code, 35 ILCS 200/11-10 (2014), and Section 125.200(a) of the Board's regulations, 35 Ill. Adm. Code 125.200(a), define "pollution control facilities" as:

any system, method, construction, device or appliance appurtenant thereto or any portion of any building or equipment, that is designed, constructed, installed or operated for the primary purpose of: eliminating, preventing, or reducing air or water pollution ...or treating, pretreating, modifying or disposing of any potential solid, liquid or gaseous pollutant which if released without treatment, pretreatment modification or disposal might be harmful, detrimental or offensive to human, plant or animal life, or to property.
4. In order to receive preferential tax treatment as pursuant to 35 ILCS 200/11-5 (2014), pollution control facilities must be certified as such by the Board, 35 ILCS 200/11-20 (2014) and 35 Ill. Adm. Code 125.200(a).
5. Upon receipt of a tax certification application, the Illinois EPA must file a recommendation on the application with the Board, 35 Ill Adm. Code 125.204(a).
6. Based on the information in the application and the purpose of the facility, it is the Illinois EPA's engineering judgment that the described facilities may be considered "pollution control facilities," pursuant to 35 Ill. Adm. Code 125.200(a), with the primary purpose of eliminating, preventing, or reducing water pollution, or as otherwise provided in 35 Ill. Adm. Code 125.200, and are eligible for tax certification from the Board.

**THIS FILING IS SUBMITTED ON RECYCLED PAPER**

WHEREFORE, the Illinois EPA recommends that the Board issue the requested tax certification.

ILLINOIS ENVIRONMENTAL PROTECTION AGENCY

By:   
Vera Herst  
Assistant Counsel  
Division of Legal Counsel

Dated: March 31, 2016

Illinois Environmental Protection Agency  
1021 North Grand Ave. E.  
P.O. Box 19276  
Springfield, Illinois 62794-9276  
217/782-5544  
217.782.9143 (TDD)



## ILLINOIS ENVIRONMENTAL PROTECTION AGENCY

1021 NORTH GRAND AVENUE EAST, P.O. BOX 19276, SPRINGFIELD, ILLINOIS 62794-9276 • (217) 782-2829  
BRUCE RAUNER, GOVERNOR LISA BONNETT, DIRECTOR

# Memorandum

To: Charles Gunnarsson, Division of Legal Counsel  
From: Al Keller, Manager, Permit Section *AK*  
Date: March 2, 2016  
Re: Edward Logan  
Logan Fertilizer  
Recommendation of Tax Certification  
Log # TC-19-13  
Property Identification # 10-27-100-008

The Bureau of Water received a request on September 16, 2013 from Logan Fertilizer for an Illinois EPA recommendation regarding the tax certification of water pollution control facilities pursuant to 35 Ill. Adm. Code 125.204. We offer the following recommendation.

The water pollution control facilities in this request include the following:

Edward Logan  
Logan Fertilizer  
30571 State Highway 107  
Griggsville, IL 62340

Section 27, T4S, R3W of the 4th PM in Pike County

Agrichemical containment facilities consisting of the concrete operational containment structure measuring 54.5 ft. x 58 ft. x 0.29 ft., the portion of the fertilizer building over the concrete operational containment structure measuring 54.5 ft. x 58 ft. x 0.29 ft., the concrete secondary containment structure (SC-3) for bulk liquid pesticides measuring 48 ft. x 88 ft. x 0.67 ft., and the portion of the building over the concrete secondary containment structure (SC-3) measuring 48 ft. x 88 ft. x 0.67 ft. as permitted under the endorsed Agrichemical Facility Permit No. AC94082989, Log No. 14091489 issued November 25, 2015. These agrichemical containment facilities are used to collect, transport, and/or store agrichemicals prior to cropland application.

These facilities are further described in the enclosed applications and supporting documents.

Based on the information included in this submittal, it is our engineering judgment that the above proposed facilities may be considered "Pollution Control Facilities" under 35 IAC 125.200(a), with the primary purpose of eliminating, preventing, or reducing water pollution, or as otherwise provided in this section, and therefore eligible for tax certification from the Illinois Pollution Control Board. The Bureau of Water therefore recommends that the Board issue the requested tax certification for these facilities.

If you have any questions regarding the above, please contact Jenny Larsen at 217/782-0610.

SAK:JML:Tax Certs\AgChem\LogTC-19-13.docx

## Watershed Unit Tax Certification Review Sheet

---

Project Name: Logan Fertilizer

Location: Griggsville, IL

Reviewer: Jenny Larsen

Date: January 25, 2016

Log number: TC-19-13

Type:  Agchem  
 Livestock

Applicant: Edward Logan  
P.O. Box 555  
Griggsville, IL 62340

Contact: Edward Logan

Phone: (217)833-2375

Facility: Logan Fertilizer  
30571 State Highway 107  
Griggsville, IL 62340

Property ID: 10-27-100-008

County: Pike

Legal Description:

S: 27 T: 4S R: 3W PM: 4th

Signature: Edward Logan

Date Control Devices installed: 1988

Title: President

Wastes:  Livestock waste is applied to cropland.  
 Agrichemical rinsate and spillage is recycled through the facility and/or land applied.  
 Other: \_\_\_\_\_

### Physical Description of Pollution Control Devices:

Facility is regulated by Agrichemical Facility Permit No. AC94082989

This facility consists of a portion of the fertilizer building over the concrete operational containment structure measuring 54.5 ft. (width) x 58 ft. (length) x 0.29 ft. (height) to prevent contaminated water runoff.

This facility also consists of the portion of the main warehouse over the concrete secondary containment structure (SC-3) measuring 48 ft. (length) x 88 ft. (width) x 0.67 (height) to prevent contaminated water runoff.

The primary purpose for these structures is eliminating, preventing or reducing water pollution.

Recommended Action: Permit the above mentioned structures.

3/25/2016

Home - Data - Public Land Survey System (PLSS)

## Public Land Survey System (PLSS)

**Instructions:** This web page will allow you to enter an Illinois address and determine its legal description to the section level-of-detail. The Public Land Survey System (PLSS) is used in legal descriptions and employs a grid system described in terms of numbered townships, ranges, and sections. Please follow the instructions below. **Note:** If the Google Maps application below is not displayed, make sure to enable Javascript on your Internet browser.

1. Enter your address in the box below and click "Search Address." Address location is provided by Google geolocation service.
2. Please check that location is accurate. If not, see step 4.
3. An information window will appear listing the County, Township, Range, and Section for the marker location. Also listed is the Principal Meridian from which that area was surveyed, USGS 7.5-minute Quadrangle name, Civil Township, Precinct name, and Latitude/Longitude coordinates.
4. If you would like to move the marker due to an incorrect geolocation, first close the information window by clicking on the "X" in the top right corner, then drag the marker to a new location. A new information window will appear with the new location information.

30571 IL-107, Griggsville, IL 62340

[Search Address](#) [Refresh Page](#)

County	Range	Section	Principal Meridian	Quadrangle	Civil Township	Precinct
Pike	4S	3W	27	4	Griggsville	

County	Griggsville Township
--------	----------------------

Latitude	39.7415699	Longitude	-90.7223343
----------	------------	-----------	-------------

World Geodetic System of 1984 (WGS84)

This location is within 200 feet of a section line. Please verify using a topographic map.

**Legend**

- Counties
- Townships
- Sections

Go Map | [Report a map error](#)

Illinois State Geological Survey | ISGS Data 2013 | ISGS

### ISGS PLSS Data Explanation

The data set within the Google Maps viewer contains Illinois Public Land Survey System (PLSS) boundaries.



APPLICATION FOR CERTIFICATION (PROPERTY TAX TREATMENT)  
 POLLUTION CONTROL FACILITY  
 AIR  WATER

ILLINOIS ENVIRONMENTAL PROTECTION AGENCY  
 P. O. Box 19276, Springfield, IL 62794-9276

This Agency is authorized to request this information under Illinois Revised Statutes, 1979, Chapter, 120, Section 502a-5. Disclosure of this information is voluntary. However, failure to comply could prevent your application from being processed or could result in denial of your application for certification.

FOR AGENCY USE					
File No.	Date Received	Certification No	Date		
Sec A  APPLICANT	Company Name <i>James + Edward Logan, dba Logan Fertilizer</i>				
	Person Authorized to Receive Certification <i>Edward Logan</i>		Person to Contact for Additional Details		
	Street Address <i>P.O. Box 555</i>		Street Address		
	Municipality, State & Zip Code <i>Griggsville, IL 62340</i>		Municipality, State & Zip Code		
	Telephone Number <i>217-833-2375</i>		Telephone Number		
	Location of Facility	Township	Range	Municipality	Township
	Quarter Section <i>27</i>	<i>04</i>	<i>3</i>	<i>Griggsville</i>	<i>Griggsville</i>
	Street Address <i>30571 State Highway 107</i>		County <i>Pike</i>	Book Number	
	Property Identification Number <i>10-27-100-005</i>		Parcel Number <i>43-033-08</i>		
Sec B  MANUFACTURING OPERATIONS	Nature of Operations Conducted at the Above Location <i>Used for storage of fertilizer and crop protection chemicals</i>				
	Water Pollution Control Construction Permit No. <i>AC 94082989</i>		Date Issued <i>1988</i>		
	NPDES PERMIT No. <i>NA</i>		Date Issued	Expiration Date	
	Air Pollution Control Construction Permit No. <i>NA</i>		Date Issued		
	Air Pollution Control Operating Permit No. <i>NA</i>		Date Issued		
Sec C  MANUFACTURING PROCESS	Describe Unit Process <i>NA. No manufacturing takes place only used for storage of crop protection chemicals and Fertilizer</i>				
	Materials Used in Process <i>NA</i>				
Sec D  POLLUTION CONTROL FACILITY DESCRIPTION	Describe Pollution Abatement Control Facility <i>The Fertilizer building is a 58x55 diked storage building for containment of crop protection chemicals and Fertilizer.</i>				

**RECEIVED**  
 SEP 16 2013  
 IEPA  
 BOW/WPC/PERMIT SECTION

Sec. E	(1) Nature of Contaminants or Pollutants <i>Crop Protection Chemicals</i>		
CONTAMINANTS			Material Retained, Captured or Recovered
	Contaminant or Pollutant	DESCRIPTION	DISPOSAL OR USE
	<i>Packaged Crop Protection Chem</i>	<i>Chemicals</i>	<i>Disposal</i>
POLLUTION CONTROL FACILITY - ACCOUNTING DATA	(2) Point(s) of Waste Water Discharge <i>NA all material contained</i>		
	Plans and Specifications Attached		Yes <input type="checkbox"/> No <input checked="" type="checkbox"/>
	(3)	Are contaminants (or residues) collected by the control facility? Yes <input checked="" type="checkbox"/> No <input type="checkbox"/>	
	(4)	Date installation completed <i>1988</i> status of installation on date of application <i>completed</i>	
	(5)	a. FAIR CASH VALUE IF CONSIDERED REAL PROPERTY:	\$ <i>207,150</i>
		b. NET SALVAGE VALUE IF CONSIDERED REAL PROPERTY:	\$ <i>36,250</i>
		c. PRODUCTIVE GROSS ANNUAL INCOME OF CONTROL FACILITY:	\$ <i>8000</i>
		d. PRODUCTIVE NET ANNUAL INCOME OF CONTROL FACILITY:	\$ <i>4000</i>
		e. PERCENTAGE CONTROL FACILITY BEARS TO WHOLE FACILITY VALUE:	% <i>38.5</i>
	Sec. F	The following information is submitted in accordance with the Illinois Property Tax Code, as amended, and to the best of my knowledge, is true and correct. The facilities claimed herein are "pollution control facilities" as defined in Section 11-10 of the Illinois Property Tax Code.	
SIGNATURE	<i>Edward L Rog-</i>		<i>President</i>
	Signature		Title
Sec. G	INSTRUCTIONS FOR COMPILING AND FILING APPLICATION		
	General: Separate applications must be completed for each control facility claimed. Do not mix types (water and air). Where both air and water operations are related, file two applications. If attachments are needed, record them consecutively on an index sheet.		
INSTRUCTIONS	Sec. A	Information refers to applicant as listed in the tax records and the person to be contacted for further details or for inspection of facilities. Define facility location by street address or legal description. A plat map location is required for facilities located outside of municipal boundaries. The property identification number is required.	
	Sec. B	Self-explanatory. Submit copies of all permits issued by local pollution control agencies. (e.g. MSD Construction Permit)	
	Sec. C	Refers to manufacturing processes or materials on which pollution control facility is used.	
	Sec. D	Narrative description of the pollution control facility, indicating that its primary purpose is to eliminate, prevent or reduce pollution. State the type of control facility. State permit number, date, and agency issuing permit. A narrative description and a process flow diagram describing the <u>pollution control facility</u> . Include a listing of each major piece of equipment included in the claimed fair cash value for real property. Include an <u>average</u> analysis of the influent and effluent of the control facility stating the collection efficiency.	
	Sec. E	List air contaminants, or water pollution substances released as effluents to the manufacturing processes. List also the final disposal of any contaminants removed from the manufacturing processes. Item (1) - Refers to pollutants and contaminants removed from the process by the pollution control facility. Item (2) - Refers to water pollution but can apply to water-carried wastes from air pollution control facilities. Submit drawings, which clearly show (a) Point(s) of discharge to receiving stream, and (b) Sewers and process piping to and from the control facility. Item (3) - If the collected contaminants are disposed of other than as wastes, state the disposition of the materials, and the value in dollars reclaimed by sale or reuse of the collected substances. State the cost of reclamation and related expense. Item (4) - State the date which the pollution control facility was first placed in service and operated. If not, explain. Item (5) - This information is essential to the certification and assessment actions. This accounting data must be completed to activate project review prior to certification by this Agency.	
	Sec. F	Self-explanatory. Signature must be a corporate authorized signature.	
		Submit to:	Attention:
	Illinois EPA P.O. Box 19276 Springfield, IL 62794-9276	Al Keller Permit Section Division of Water Pollution Control	Donald E. Sutton Permit Section Division of Air Pollution Control

PHYSICAL CHARACTERISTICS

ROOFING

Metal

WALLS

Frame B 1  
 Brick Yes  
 Metal  
 Guard

FRAMING

B 1

FINISH

1 UP SF  
 8286 0  
 Total 8286 0

HEATING AND AIR CONDITIONING

Heat B 1  
 0 8286

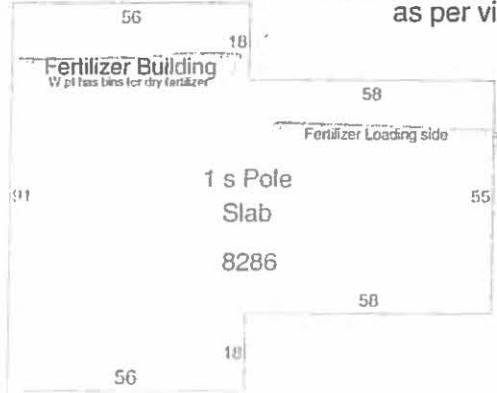

NEED to apply for PC on 58 x 55 pt as per visit w/ED on 05-07-13

Item Description Units Cost T

M & S Cost Database Date: 07/2006

Base Cost	8286	21.18	17
Base Cost	8286	21.18	17
Exterior Walls	8286	3.44	1
Exterior Walls	8286	3.44	1
Basic Structure Cost	8286	24.62	21
Basic Structure Cost	8286	24.62	21
Physical & Functional	0	0.00	13
Physical & Functional	0	0.00	13
Depreciated Cost	8286	7.88	6
Depreciated Cost	8286	7.88	6
Rounded Total	0	0.00	6
Rounded Total	0	0.00	6

Total Exterior Features Value			
Total Exterior Features Value			
Depreciated Ext Features			
Depreciated Ext Features			
Total Before Adjustments			6
Total Before Adjustments			6
Neighborhood Adjustment			
Neighborhood Adjustment			
TOTAL VALUE			6
TOTAL VALUE			6

(LCM: 100.0

SPECIAL FEATURES

Description	Value

SUMMARY OF IMPROVEMENTS

ID	Use	Stry Hgt	Const Type	Grade	Year Const	Eff Year	Cond	Base Rate	Feat- ures	Adj Rate	Size or Area	Computed Value	Phys Depr	Obsol Depr	Market Adj	% Comp	Value
C	FERTSTG					1988	1988	AV	0.00	11	0.00	8286	0	0	0	100	6528

Data Collector/Date

Appraiser/Date

Neighborhood

Supplemental Cards

65280

Neigh 1003 AV

TOTAL IMPROVEMENT VALUE

Fertilizer  
43-033-08  
North view

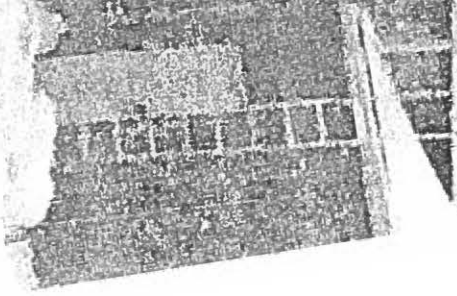
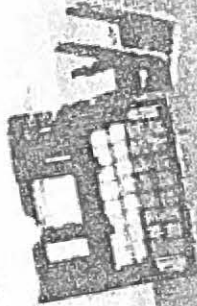

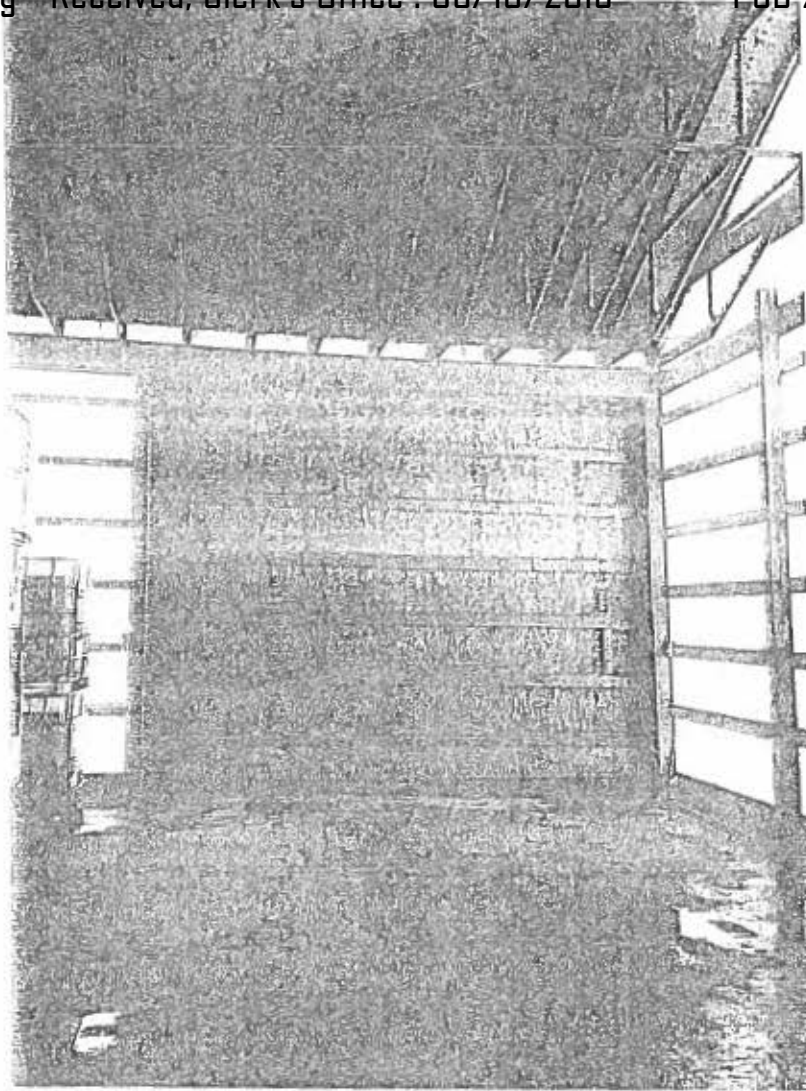

Fertilizer Building  
(Storage section)  
58' x 55'

43-033-08



Fertilizer Building + Storage

58' x 55'

Sloping drive with dike

43-033-08

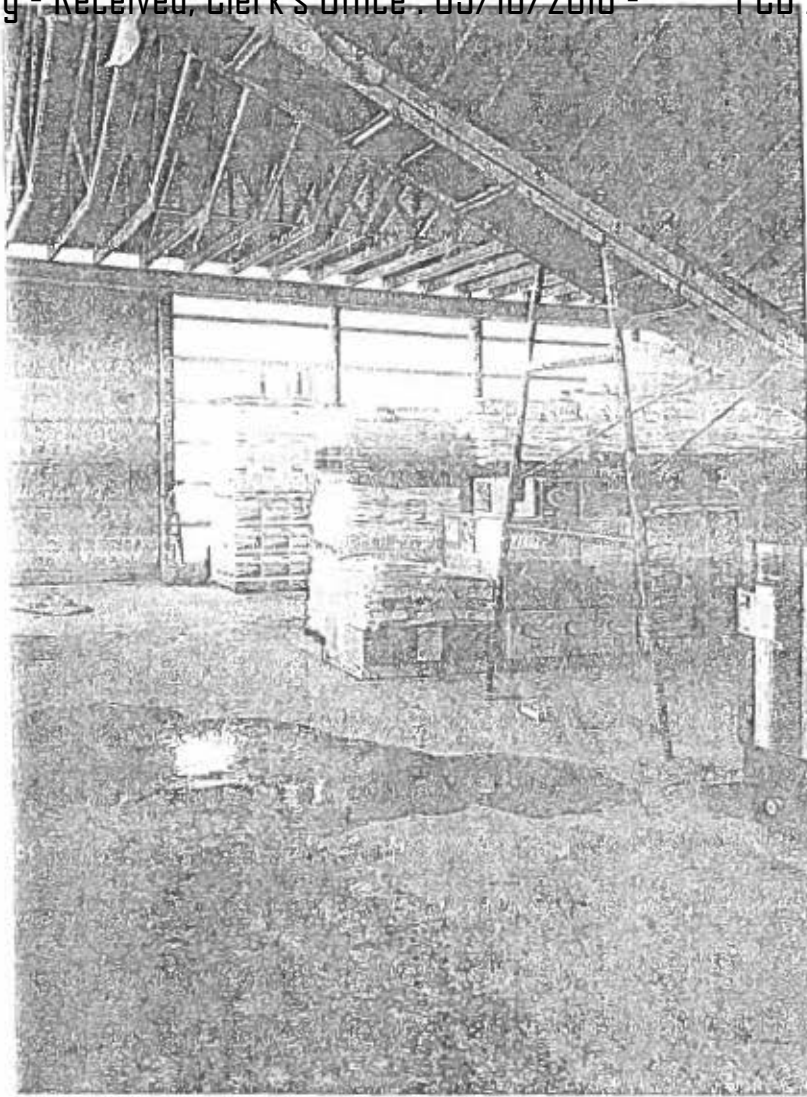

Fertilizer Building + Storage  
58' x 55'  
Pollution Control area  
43-033-08

APPLICATION FOR CERTIFICATION (PROPERTY TAX TREATMENT)  
 POLLUTION CONTROL FACILITY  
 AIR  WATER

ILLINOIS ENVIRONMENTAL PROTECTION AGENCY  
 P. O. Box 19276, Springfield, IL 62794-9276

This Agency is authorized to request this information under Illinois Revised Statutes, 1979, Chapter, 120, Section 502a-5. Disclosure of this information is voluntary. However, failure to comply could prevent your application from being processed or could result in denial of your application for certification.

FOR AGENCY USE				
File No.	Date Received	Certification No	Date	
Sec A  APPLICANT	Company Name James + Edward Logan dba Logan Fertilizer			
	Person Authorized to Receive Certification Edward Logan		Person to Contact for Additional Details	
	Street Address P.O. Box 555		Street Address	
	Municipality, State & Zip Code Griggsville, IL 62340		Municipality, State & Zip Code	
	Telephone Number 217-833-2355		Telephone Number	
	Location of Facility Quarter Section 27		Township 04	Range 3
	Street Address 30571 State Highway 107		Municipality Dike	Township Griggsville
	Property Identification Number 10-27-10008		County Dike	Book Number
	Nature of Operations Conducted at the Above Location used for storage of bulk and packaged crop protection chemicals			
MANUFACTURING OPERATIONS	Water Pollution Control Construction Permit No. AC 94082989		Date Issued 1988	
	NPDES PERMIT No. NA		Date Issued Expiration Date	
	Air Pollution Control Construction Permit No. NA		Date Issued	
	Air Pollution Control Operating Permit No. NA		Date Issued	
MANUFACTURING PROCESS	Describe Unit Process NA. No manufacturing takes place. The warehouse is used for storage of bulk and packaged chemicals			
	Materials Used in Process NA			
Sec. D  POLLUTION CONTROL FACILITY DESCRIPTION	Describe Pollution Abatement Control Facility The main warehouse is a 48 x 88 diked storage facility. This building is used for storage and spill containment of bulk and packaged crop protection chemicals.			

**RECEIVED**

SEP 16 2013

IEPA  
BOWWPC/PERMIT SECTION





IMPROVEMENT DATA

PHYSICAL CHARACTERISTICS

ROOFING  
Metal

WALLS  
Frame B 1 2 U  
Brick Yes  
Metal  
Guard

FRAMING  
Wd Jst B 1 2 U  
0 1920 0 0

FINISH  
1 UF SF FO FD  
7680 0 0 0  
Total 7680 0 0 0

HEATING AND AIR CONDITIONING  
Heat B 1 2 U  
0 7680 0 0  
A/C 0 7680 0 0

- 01 Comm. Canopy
- 02 Conc. Paving
- 03 Truck Scale

NEED to apply for PC on 48x88 in North part of Main Warehouse. as per visit w/ED 05-07-13

Reviewed at 2012 BOR  
We have not received any Pollution Control paperwork for the 48x88 part of this bldg on Card 1 48

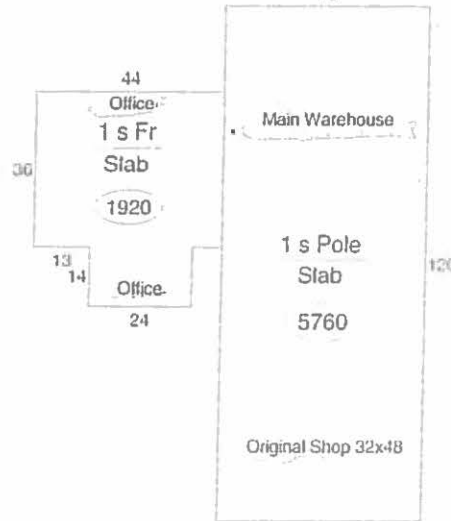

Adding new additional shop in 2013

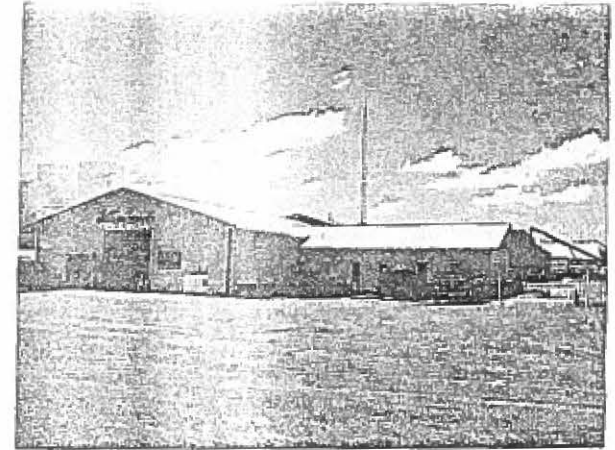

(LCM: 100.00)

SPECIAL FEATURES

SUMMARY OF IMPROVEMENTS

Description	Value	ID	Use	Sty Hgt	Const Type	Grade	Year Const	Eff Year	Cond	Base Rate	Feat-ures	Adj Rate	Size Area	Or	Comput Value	Depn	Market Adj	% Comp	Value
C : Remod 1995		C	WHSESTOR	0.00	C		1988	1988	AV	0.00	H	0.00	7680				0	100	95100
		01	COMCNPYA	0.00	C		1995	1995	AV	20.55	H	20.55	24x30		24,800	24	0	100	11340
		02	PAV	0.00	C	6	1995	1995	AV	1.99	H	1.99	320		320	32	0	100	1460
		03	SCALES	0.00	C		1995	1995	AV	0.39	H	0.39	10x40		39100	39	0	100	31200

Data Collector/Date

Appraiser/Date

Neighborhood

Supplemental Cards

Neigh 1003 AV

TOTAL IMPROVEMENT VALUE

139100



Warehouse - N. door  
Bulk storage tanks inside  
43-033-08



Ware house 48' x 88'  
Ramp at North door  
showing incline from  
ground level into warehouse  
43-033-08

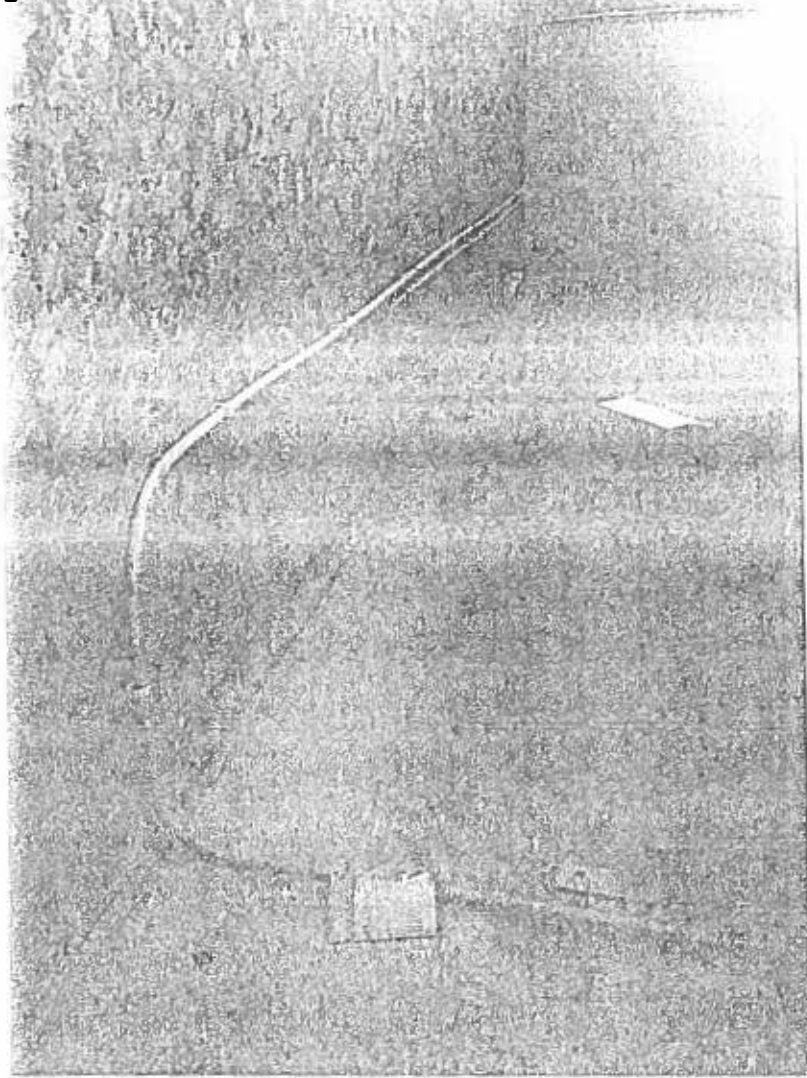

Warehouse  
48' x 88'  
Bulk storage tanks  
and 6" concrete dike  
43-033-08

W1498080001

State of Illinois  
Department of Agriculture  
**AGRICHEMICAL CONTAINMENT PERMIT**

Floyd McKinney  
WPC: Springfield  
APC: Springfield  
Records  
Binds JML

R

<b>Permittee:</b> Logan Agri Service, Inc. P.O. Box 555 Griggsville, IL 62340	<b>Facility ID Number:</b> AC1493120000 <b>Facility Location:</b> Griggsville
<b>Permit #:</b> AC94082989 <b>Facility Type:</b> Commercial: Retail Dealer <b>Date Issued:</b> November 25, 2014	<b>Log Number:</b> 14097489 <b>Date Received:</b> September 4, 2014 <b>Expiration Date:</b> November 25, 2019

Permit is hereby granted to the above designated permittee to construct and operate an agrichemical containment facility as follows:

**OPERATIONAL CONTAINMENT STRUCTURES**

Operation of an existing reinforced concrete operational containment structure measuring 47.92' (width) x 76' (length) x 0.5' (height) with a total design capacity of 543 cubic feet (ft.<sup>3</sup>). The floor shall slope to one (1) of two (2) sumps, each sump measuring 2' (width) x 4' (length) x 2' (depth) to facilitate the collection and recovery of all escaped product and/or agrichemical wastewater. All recovered effluent shall be transferred to one (1) of two (2) 1,600 gallon recovery tanks with a manually activated sump pump. Segregation shall be performed based upon the applicable target crop and label use. The loading, unloading, and washing of bulk liquid agrichemical transportation and application equipment shall be performed upon the herein permitted structure. This structure shall be referred to as OC-1.

Operation of an existing reinforced concrete secondary containment structure measuring 11.5' (width) x 20.08' (length) x 2' (height) with a total design capacity of 432 cubic feet (ft.<sup>3</sup>). The floor shall slope to a single sump measuring 1' (diameter) x 1.17' (depth) to facilitate the collection and recovery of all escaped product and/or agrichemical wastewater. All recovered effluent shall be transferred to one (1) of the two (2) aforementioned 1,600 gallon recovery tanks with a manually activated sump pump. Segregation shall be performed based upon the applicable target crop and label use. All mixing of liquid agrichemicals shall be performed upon the herein permitted structure. This structure shall be referred to as OC-2.

Operation of an existing reinforced concrete operational containment structure measuring 11.17' (width) x 16.67' (length) x 0.1' (depth) with a total design capacity of 16 cubic feet (ft.<sup>3</sup>). The floor shall slope to the lowest elevation to facilitate the collection and recovery of all escaped product and/or agrichemical wastewater. All recovered effluent shall be transferred to a single 200 gallon recovery tank with a manually activated sump pump. All treating of seed with pesticides shall be performed within the said structure. This structure shall be referred to as OC-3.

IEPA - DIVISION OF RECORDS MANAGEMENT  
RELEASABLE

MAY 01 2015

REVIEWER JRM



RECEIVED  
NOV 18 2014

IEPA  
BOW/WPC/PERMIT SECTION

State of Illinois  
Department of Agriculture  
**AGRICHEMICAL CONTAINMENT PERMIT**

**SECONDARY CONTAINMENT STRUCTURES**

Operation of an existing reinforced concrete secondary containment structure measuring 30' (width) x 70' (length) x 2' (height) with a total design capacity of 8,706 cubic feet (ft.<sup>3</sup>). The capacity shall include the volume provided by overflow into the adjacent secondary containment structure (SC-2). The floor shall slope to the lowest elevation to facilitate the collection and recovery of all escaped product and/or agrichemical wastewater. All recovered effluent shall be transferred to one (1) of the two (2) aforementioned 1,600 gallon recovery tanks with a manually activated sump pump. Segregation shall be performed based upon the applicable target crop and label use. All bulk liquid pesticides shall be stored within the herein permitted structure. This structure shall be referred to as SC-1.

Operation of an existing reinforced concrete secondary containment structure measuring 30' (width) x 41' (length) x 4.6' (height) with a total design capacity of 8,706 cubic feet (ft.<sup>3</sup>). The capacity shall include the volume provided by overflow into the adjacent secondary containment structure (SC-1). The floor shall slope to a single sump measuring 1' (diameter) x 1.17' (depth) to facilitate the collection and recovery of all escaped product and/or agrichemical wastewater. All recovered effluent shall be transferred to one (1) of the two (2) aforementioned 1,600 gallon recovery tanks with a manually activated sump pump. Segregation shall be performed based upon the applicable target crop and label use. All bulk liquid fertilizer shall be stored within the herein permitted structure. This structure shall be referred to as SC-2.

Operation of an existing reinforced concrete secondary containment structure measuring 48' (width) x 88' (length) x 0.67' (height) with a total design capacity of 2,631 cubic feet (ft.<sup>3</sup>). The floor shall slope to the lowest elevation to facilitate the collection and recovery of all escaped product and/or agrichemical wastewater. All recovered effluent shall be transferred to one (1) of the two (2) aforementioned 1,600 gallon recovery tanks with a manually activated sump pump. Segregation shall be performed based upon the applicable target crop and label use. Bulk liquid pesticides shall be stored within the herein permitted structure. This structure shall be referred to as SC-3.

Operation of an existing reinforced concrete secondary containment structure measuring 60' (width) x 100' (length) x 0.5' (height) with a total design capacity of 2,868 cubic feet (ft.<sup>3</sup>). The floor shall slope to the lowest to facilitate the collection and recovery of all escaped product and/or agrichemical wastewater. All recovered effluent shall be transferred to a single 200 gallon recovery tank with a manually activated sump pump. Bulk liquid pesticides shall be stored within the said structure. This structure shall be referred to as SC-4.

**DRY FERTILIZER STRUCTURES**

Operation of an existing bulk dry fertilizer storage building measuring 56' (width) x 93' (length) with an estimated total storage capacity of 1,000 tons. The structure is composed of five (5) storage bins, each bin measuring 18' (width) x 40' (length) with an estimated storage capacity of 200 tons each.

All bulk dry fertilizer shall be stored within the herein permitted structure.

Operation of an existing reinforced concrete operational containment structure measuring 26' (width) x 93' (length). The end loader transfer of bulk dry fertilizer between storage and the blender shall be performed upon the herein permitted structure.



State of Illinois  
Department of Agriculture  
**AGRICHEMICAL CONTAINMENT PERMIT**

Operation of an existing reinforced concrete operational containment structure with the greatest dimensions measuring 6' (width) x 82.3' (length). The unloading of bulk dry fertilizer transportation and application equipment shall be performed upon the herein permitted structure.

Operation of an existing reinforced concrete operational containment structure measuring 54.5' (width) x 58' (length) x 0.29' (height) with a total design capacity of 839 cubic feet (ft.<sup>3</sup>). The floor shall slope to a single sump measuring 0.92' (diameter) x 1.33' (depth) to facilitate the collection and recovery of all escaped product and/or agrichemical wastewater. All recovered effluent shall be transferred to one (1) of two (2) 110 gallon recovery tanks with a manually activated sump pump. Segregation shall be performed based upon the applicable target crop and label use. All blending of bulk dry fertilizer, including the blending of dry fertilizer with pesticides, and all loading of bulk dry fertilizer transportation and application equipment shall be performed upon the herein permitted structure.

There shall be no discharge of wastewater from the herein permitted facilities.

This permit has been reviewed and approved by the Illinois Environmental Protection Agency per the attached permit endorsement. This permit is subject to standard conditions on the reverse side of this document and the following special conditions:

**SPECIAL CONDITION 1:** The permittee shall provide backflow protection in accordance with the Illinois Department of Public Health Plumbing Code (77 Ill. Adm. Code 890) and the Illinois Environmental Protection Agency's Technical Policy Statement (35 Ill. Adm. Code 653.803(c)(4)).

**SPECIAL CONDITION 2:** The permittee may discharge accumulated precipitation from the herein permitted bulk liquid fertilizer secondary containment structure (SC-2) pursuant to 8 Illinois Administrative Code 255.110 (a) (2) (A) and (B).

**SPECIAL CONDITION 3:** The permittee shall operate the herein permitted operational containment structures pursuant to 8 Illinois Administrative Code 255.90 (a) (b) (c) and (f), and 8 Illinois Administrative Code 255.110 (c).

**SPECIAL CONDITION 4:** The permittee shall perform all operations involving the impregnation of bulk dry fertilizer with pesticides, in accordance with 8 Illinois Administrative Code 255.150. The permittee shall maintain and manage the operational containment structure employed for the pesticide inductor pursuant to 8 Illinois Administrative Code 255.90.

**SPECIAL CONDITION 5:** The permittee shall operate the exposed dry fertilizer operations pursuant to 8 Illinois Administrative Code 255.140 (a), (c) and (d).

**SPECIAL CONDITION 6:** The permittee shall provide means for the safe emergency access to and exit from the herein permitted bulk liquid fertilizer secondary containment structure (SC-2) pursuant to 8 Illinois Administrative Code 255.80 (c) (2) (E).





STATE OF ILLINOIS  
COUNTY OF SANGAMON

)  
)  
)  
)  
)

CERTIFICATE OF SERVICE

I, the undersigned attorney at law, hereby certify that I have served on the date of March 18, 2016, the attached APPEARANCE and RECOMMENDATION OF THE ILLINOIS ENVIRONMENTAL PROTECTION AGENCY, upon the following persons by First Class U.S. Mail, with proper postage or delivery charges prepaid:

Steve Santarelli  
Illinois Department of Revenue  
101 West Jefferson  
P.O. Box 19033  
Springfield, Illinois 62794

Edward Logan  
P.O. Box 555  
Griggsville, Illinois 62340

[Electronic Filing]

Clerk  
Illinois Pollution Control Board  
James R. Thompson Center  
100 West Randolph Street, Suite. 11-500  
Chicago, Illinois 60601

ILLINOIS ENVIRONMENTAL PROTECTION AGENCY

/s/ Vera Herst  
Assistant Counsel  
Division of Legal Counsel  
1021 North Grand Avenue East  
P.O. Box 19276  
Springfield, Illinois 62794-9276  
217.782.5544  
217.782.9143 (TDD)

STATE OF ILLINOIS )  
 )  
COUNTY OF SANGAMON )  
 )

**CERTIFICATE OF SERVICE**

I, the undersigned attorney at law, hereby certify that I have served on the date of March 31, 2016, the attached APPEARANCE and RECOMMENDATION OF THE ILLINOIS ENVIRONMENTAL PROTECTION AGENCY, upon the following persons by First Class U.S. Mail, with proper postage or delivery charges prepaid:

Steve Santarelli  
Illinois Department of Revenue  
101 West Jefferson  
P.O. Box 19033  
Springfield, Illinois 62794

Edward Logan  
P.O. Box 555  
Griggsville, Illinois 62340

**[Electronic Filing]**

Clerk  
Illinois Pollution Control Board  
James R. Thompson Center  
100 West Randolph Street, Suite. 11-500  
Chicago, Illinois 60601

ILLINOIS ENVIRONMENTAL PROTECTION AGENCY

/s/ Vera Herst  
Assistant Counsel  
Division of Legal Counsel  
1021 North Grand Avenue East  
P.O. Box 19276  
Springfield, Illinois 62794-9276  
217.782.5544  
217.782.9143 (TDD)